

PLAN

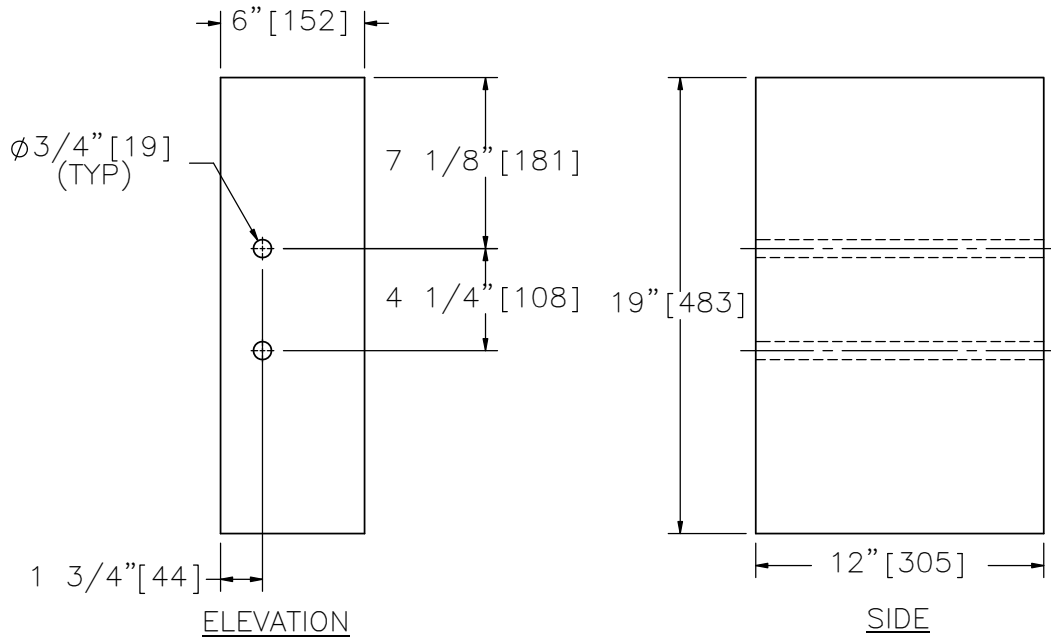

ELEVATION

SIDE

THRIE BEAM TIMBER BLOCKOUT FOR STEEL POSTS



PDB18

SHEET NO.

DATE:

1 of 2

9/8/2011

### SPECIFICATIONS

Blockouts shall be made of Southern Yellow Pine Timber (SYP) grade no. 1 or better. Grading shall be in accordance with the rules of the West Coast Lumber Inspection Bureau, Southern Pine Inspection Bureau or other appropriate timber association. Timber for the blockouts shall be either rough sawn (un-planed) or S4S (surfaced four sides) with nominal dimensions indicated. The size tolerance of blockouts in the direction parallel to the axis of the bolt holes shall not be more than  $\pm 1/4$  in. [6]. Only one type of surface finish shall be used for any one continuous length of guardrail.

All timber shall receive a preservation treatment in accordance with AASHTO M133 after all end cuts are made and holes are drilled.

Dimensional tolerances not shown or implied are intended to be those consistent with the proper functioning of the part, including its appearance and accepted manufacturing practices.

### INTENDED USE

This blockout is a component of the STG02 and STG03a MGS W-beam to Thrie Beam transition systems. It is attached to posts PWE06 and PWE13b and asymmetrical W-beam to Thrie Beam transition section RWT02 with 14-in. long zinc-coated FBB06 bolts and nuts.

### CONTACT INFORMATION

Midwest Roadside Safety Facility  
Nebraska Transportation Center  
University of Nebraska-Lincoln  
130 Whittier Research Center  
2200 Vine Street  
Lincoln, NE 68583-0853  
(402) 472-0965  
Email: [mwrfsf@unl.edu](mailto:mwrfsf@unl.edu)  
Website: <http://mwrfsf.unl.edu/>

## THRIE BEAM TIMBER BLOCKOUT FOR STEEL POSTS

**PDB18**

SHEET NO.

DATE:

2 of 2

9/8/2011

