

APPENDIX A. DETAILS OF THE OREGON 3-TUBE CURB MOUNT BRIDGE RAIL

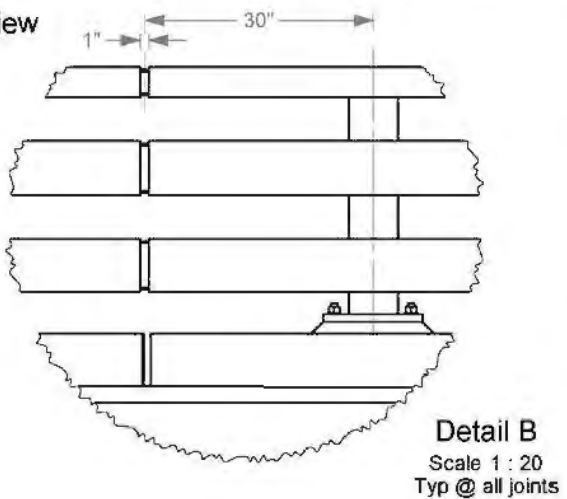

- 1a. 7/8 hardware typical x 4 at each post.
3/4 hardware typical x 6 at each post.
- 1b. All steel components except rebar and Anchor Plates (see next sheet), but including hardware, shall be galvanized.

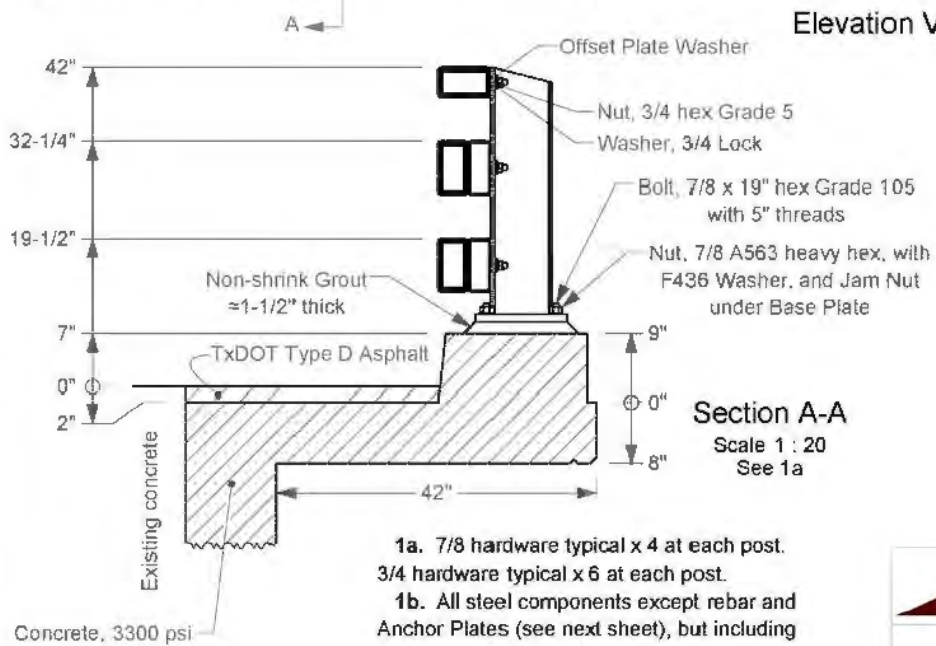
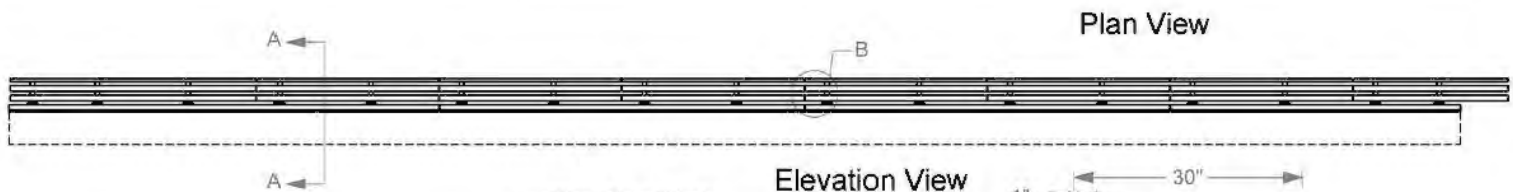
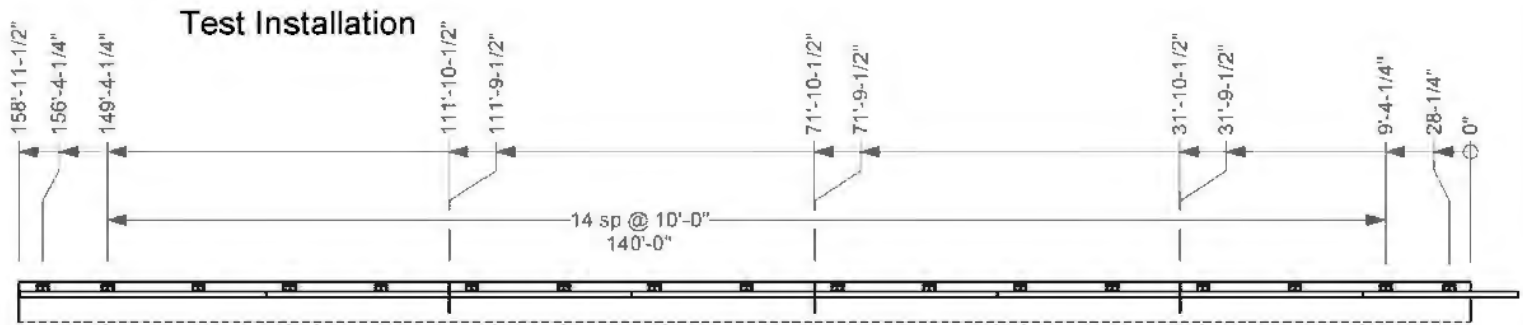

Roadside Safety and
Physical Security Division -
Proving Ground

Project #612711	O-DoT 3-Tube Curb Mount Rail	2019-12-11
Drawn by GES	Scale 1:200	Sheet 1 of 7 Test Installation

O:\Accreditation\17025-2017\EIR-000 Project Files\612711 - Oregon Bridge Rail - Schulz\Drafting_612711\612711 Drawing

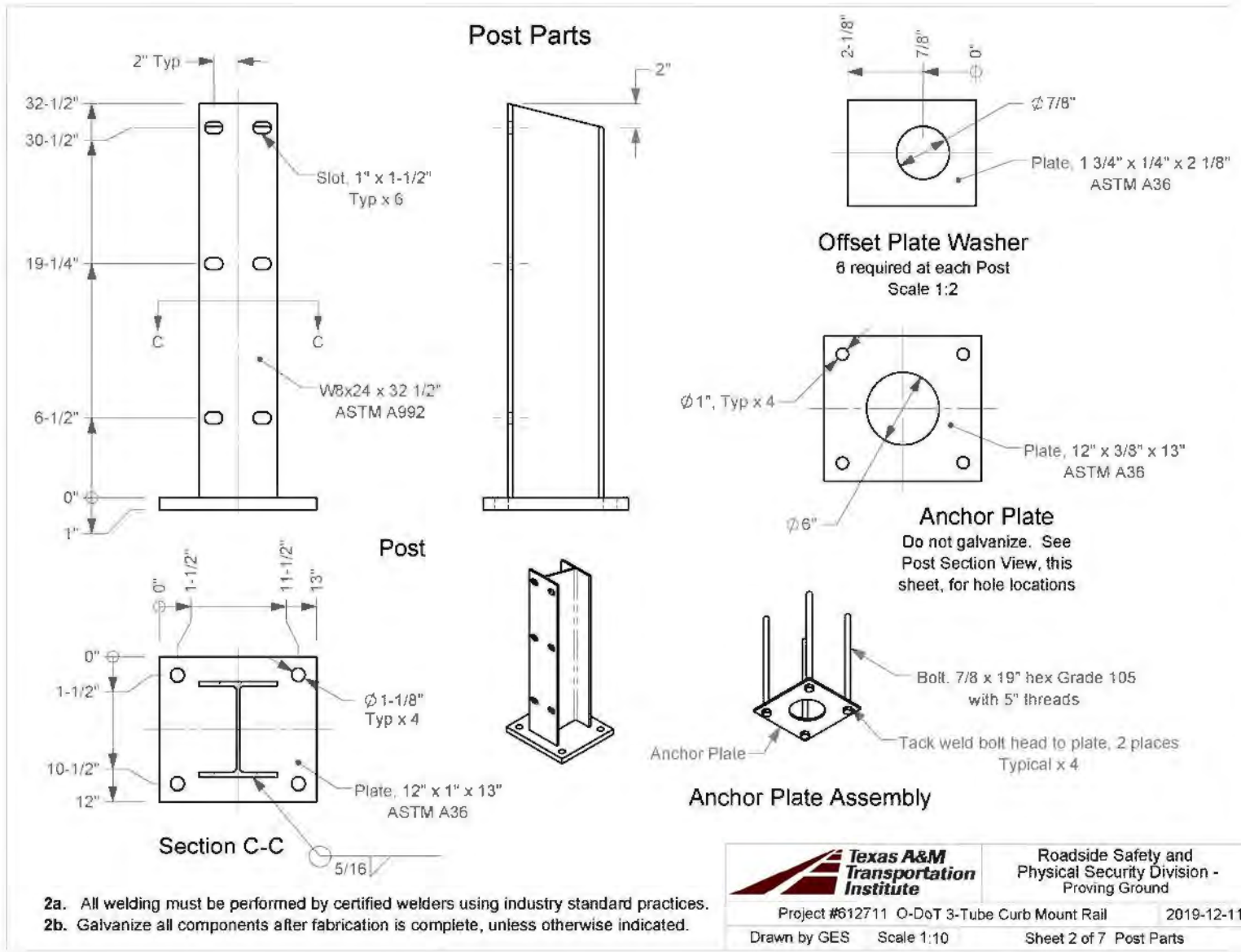

Q:\Accreditation-17025-2017-EIR-000 Project Files\612711 - Oregon Bridge Rail - Schulz\Drawing, 612711\612711 Drawing

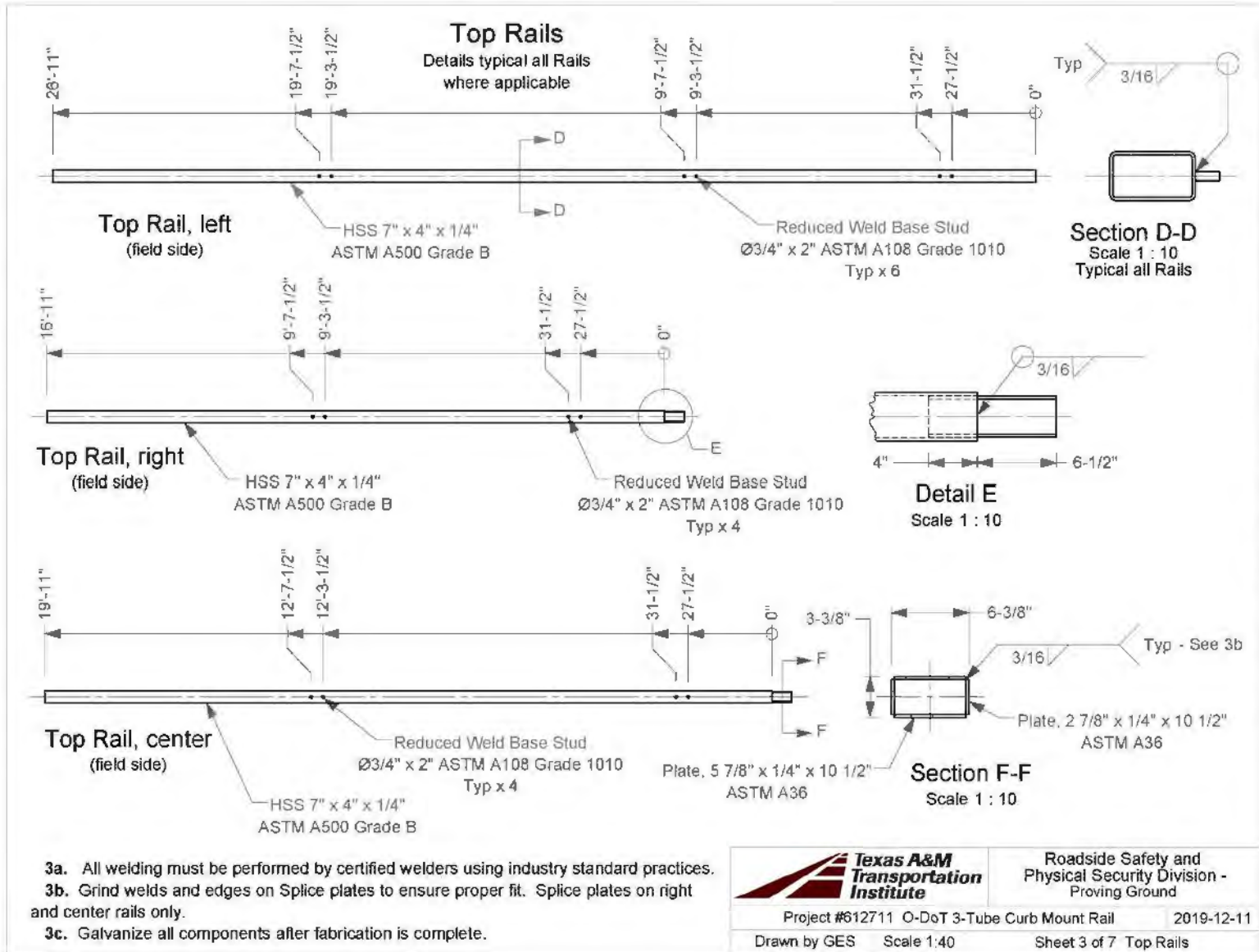

Q:\Accreditation-17025-2017-EIR-000 Project Files\612711 - Oregon Bridge Rail - Schulz\Drafting, 612711\612711 Drawing

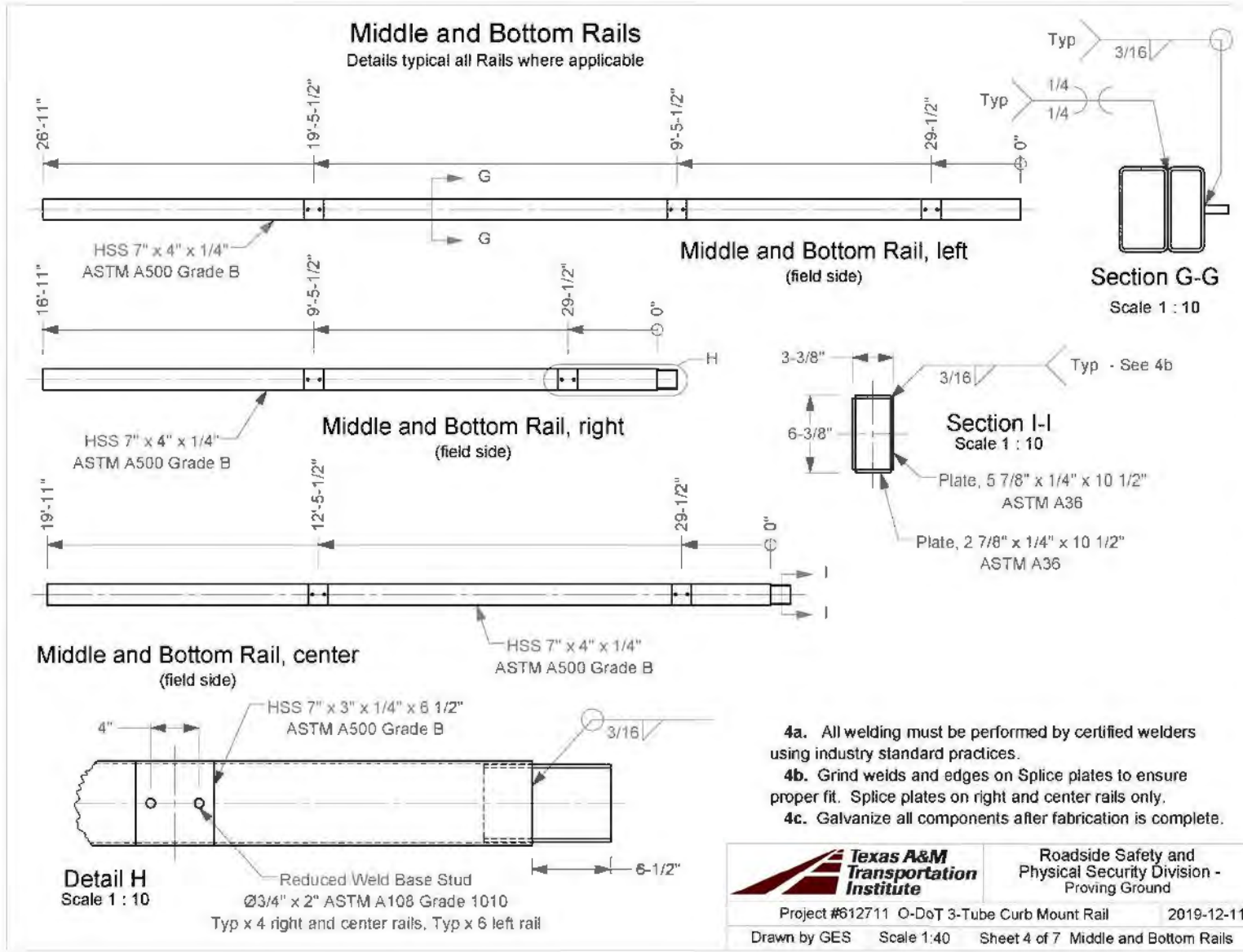

Q:\Accreditation-17025-2017-IEIR-000 Project Files\612711 - Oregon Bridge Rail - Schulz\Drawing, 612711\612711 Drawing

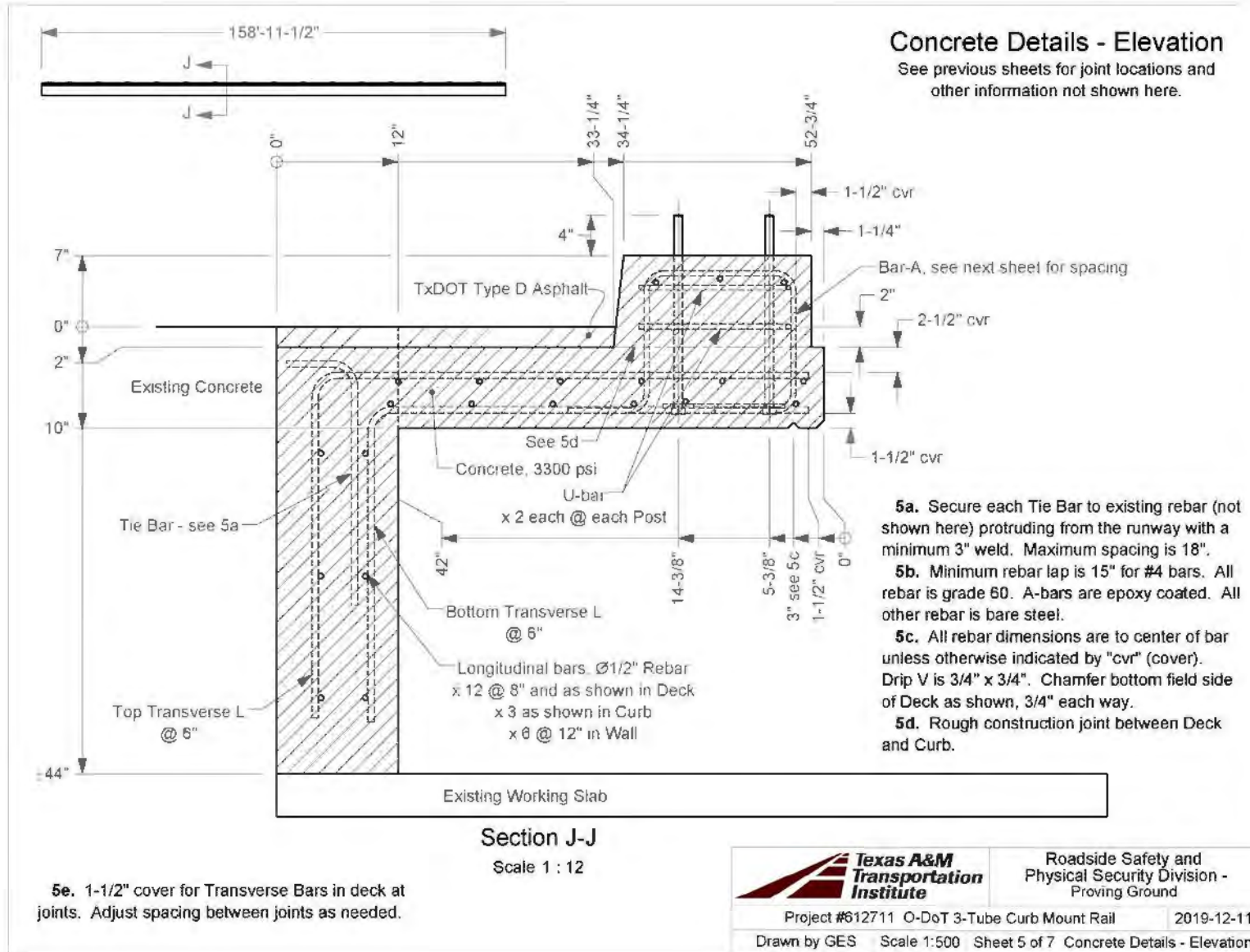

Concrete Details - Plan

See previous sheets for joint locations and other information not shown here.

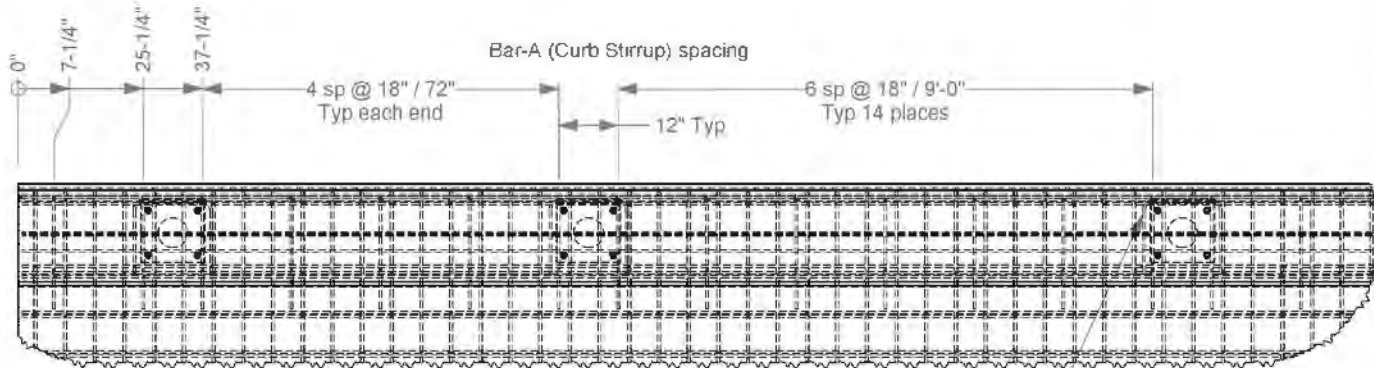
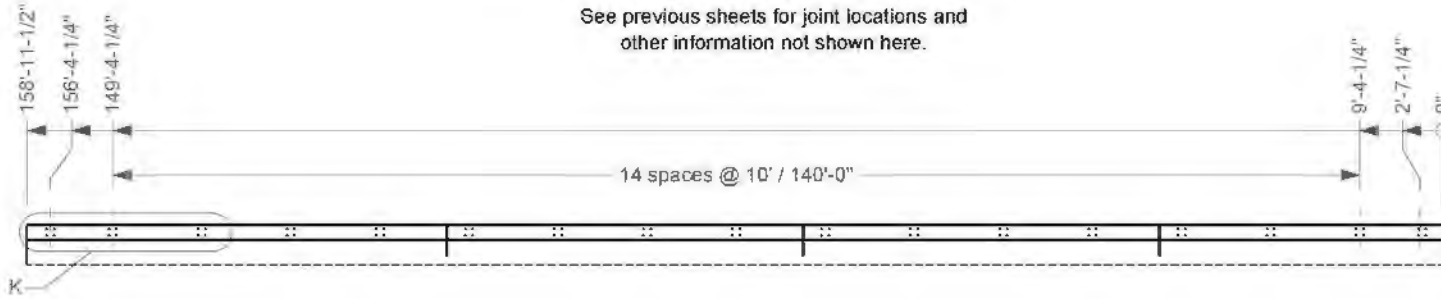

Detail K

Scale 1 : 30

6a. 1-1/2" cover for Transverse Bars in deck at joints. Adjust spacing between joints as needed.



Roadside Safety and Physical Security Division - Proving Ground

Project #612711 O-DoT 3-Tube Curb Mount Rail 2019-12-11

Drawn by GES Scale 1:200 Sheet 6 of 7 Concrete Details - Plan

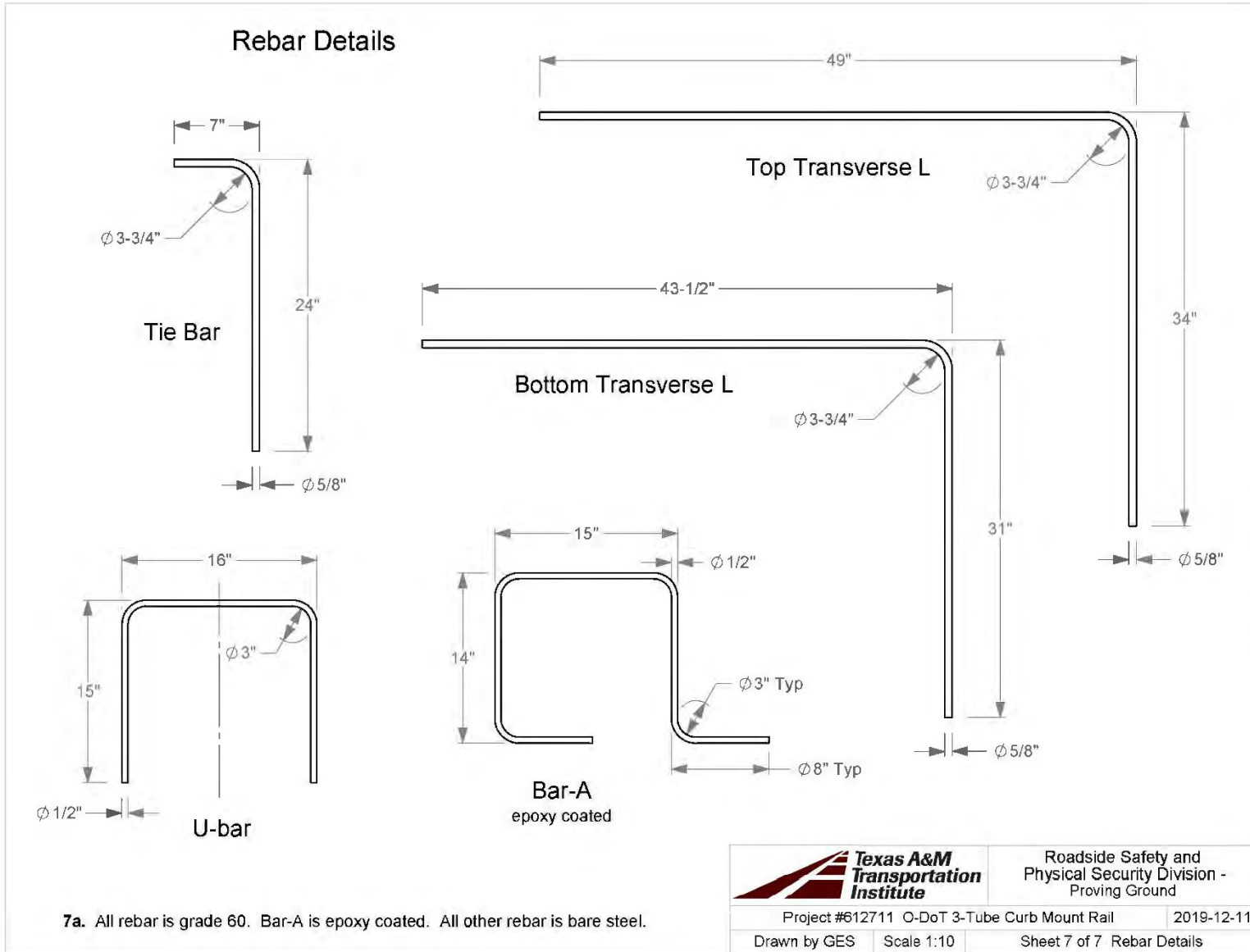

		Roadside Safety and Physical Security Division - Proving Ground
Project #612711 O-DoT 3-Tube Curb Mount Rail		2019-12-11
Drawn by GES	Scale 1:10	Sheet 7 of 7 Rebar Details

Q:\Accreditation-17025-2017\EIR-000 Project Files\612711 - Oregon Bridge Rail - Schulz\Drafting, 612711\612711 Drawing