

TEST LEVEL 3 - 7 BAY

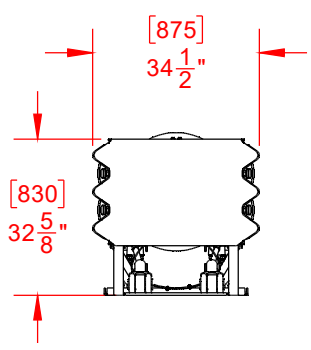

## Universal TAU-M™ TL-3



SCI38b

Lindsay Transportation Solutions, 180 River Rd., Rio Vista CA. 94571, 888-800-3691  
www.theroadzipper.com

SHEET NO.

DATE:

1 OF 2

08/24/18

## INTENDED USE

The Universal TAU-M™ system is a re-directive non-gating crash cushion and is ideally suited for hazards such as the ends of rigid barriers, tollbooths, utility poles, and more. This system is designed to reduce severity of an errant vehicle impact and to safely stop or redirect an errant vehicle away from roadside or median hazards. These types of systems are typically applied to locations where head-on and angled impacts are likely to occur and it is desirable to have the majority of post impact trajectories on the impact side of the system.

The Universal TAU-M™ parallel crash cushions can protect hazards up to 30' [762] and offers a variety of anchoring options to fit many applications. Standard non-proprietary three-beam transitions may enable protecting much wider hazards. Test Level 3 systems are 7 Bays.

The TAU-II™ (SCT01a-b) may be converted to a TAU-M.

## APPROVALS

The Universal TAU-M™ system has been fully tested in conformance with MASH Test Level 3 and is determined eligible for Federal reimbursement by FHWA.

FHWA Eligibility Letters: CC-147, November 2, 2018

## CONTACT INFORMATION

Lindsay Transportation Solutions  
180 River Rd.  
Rio Vista, CA 94571  
[www.barriersystemsinc.com](http://www.barriersystemsinc.com)  
Phone: 888-800-3691 or 707-374-6800  
Fax: 707-374-6801  
Email: [info@barriersystemsinc.com](mailto:info@barriersystemsinc.com)

## Universal TAU-M™ TL-3

# SCI38b



SHEET NO.

DATE:

2 OF 2

08/24/18

Lindsay Transportation Solutions, 180 River Rd., Rio Vista CA. 94571, 888-800-3691  
[www.theroadzipper.com](http://www.theroadzipper.com)