

NOTE: RAIL RWM14a RESTS ON THE FPP02 SHELF CLIP.
BOLT FBB04 CONNECTS THE FPP02 SHELF CLIP.
PDB01 BLOCKOUT AND PDF01 POST. POST IS NOT
ATTACHED TO RAIL RWM14a AT POST 2.

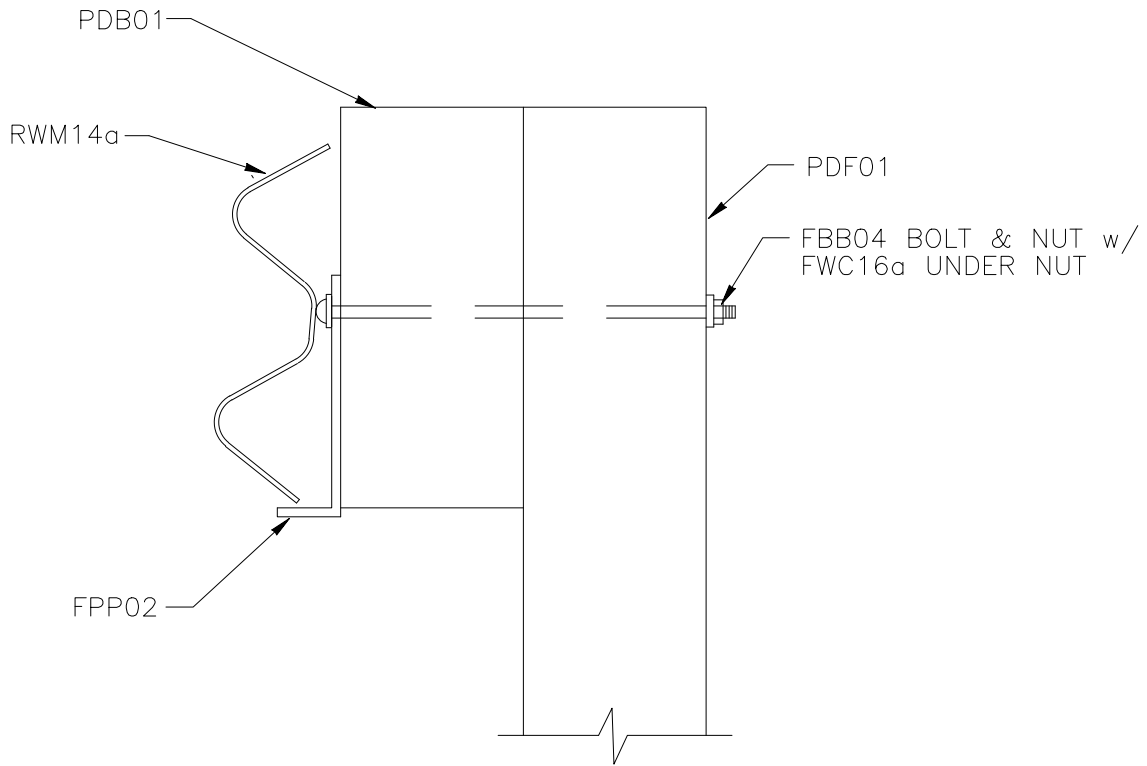

DETAIL E: SHELF CLIP ATTACHMENT

MODIFIED ECCENTRIC LOADER BREAKAWAY CABLE TERMINAL

SEW05

SHEET NO.

REF. NO.

6 of 6