

ELEVATION

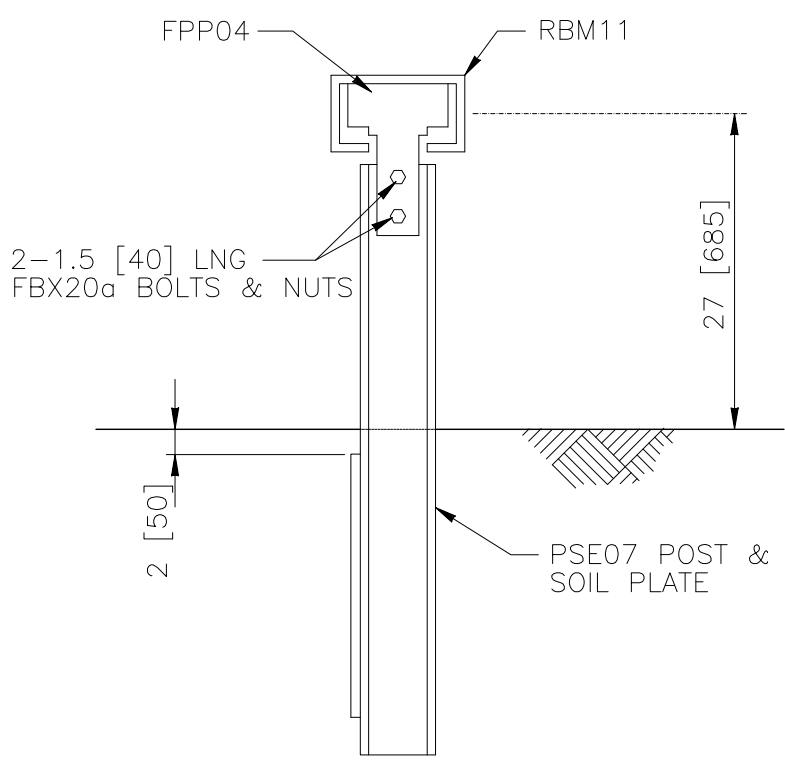

WEAK-POST BOX-BEAM MEDIAN BARRIER



SGM03

SHEET NO.	DATE:
1 of 2	7/14/2005

INTENDED USE

Weak-post box-beam median barriers are commonly used where dynamic deflections of at least 67 inches [1700 mm] are acceptable. This system must be anchored with a suitable terminal system like SEB02. SGM-03 is a Test Level 3 barrier.

COMPONENTS

Unit length = 216 inches [5490 mm]

Designator	Component	Number
FBX20a	Hex-bolt (1.5 [40]) and nut	6
FBX20b	Hex splice bolt (1.5 [40])	8
FPP04	Rail support plate	3
FWC20b	Splice washer	8
PSE07	Post and soil plate	3
RBS02	Splice plate	2
RBM11	Box-beam rail	1

APPROVALS

FHWA Acceptance Letter B-64.

REFERENCES

M.E. Bronstad, J.E. Michie, and J.D. Mayer, Jr., *Performance of Longitudinal Traffic Barriers*, National Cooperative Highway Research Program Report Number 289, Transportation Research Board, 1987.

J.D. Michie and M.E. Bronstad, *Location, Selection, and Maintenance of Highway Traffic Barriers*, National Cooperative Highway Research Program Report Number 118, Highway Research Board, 1971.

CONTACT INFORMATION

Federal Highway Administration
Office of Safety
400 Seventh Street, SW
Washington, DC 20590
202-366-2288

WEAK-POST BOX-BEAM MEDIAN BARRIER

SGM03

SHEET NO.

DATE

2 of 2

07/14/2005

