

ITEM NO.	PART NO.	DESCRIPTION	QTY.	WEIGHT EA.	DWG NO.
1	2083131SLM	SL WIRE ROPE LINEPOST 1370mm WHITE - 3 SLOTS	1	7	FX747-1
2	2110162SLM	SL WIRE ROPE HALF TIE 8mm ALUMINIUM	3	0.04	FX747-2
3	2200036SLM	SL WIRE ROPE 19mm DIA.	AS REQUIRED		
4	2083070SLM	SL WIRE ROPE POST SOCKET	1	0.37	FX747-4
5	2083072SLM	SL WIRE ROPE LINEPOST CAP	1	0.07	FX747-3
6	2083073SLM	SL WIRE ROPE LINEPOST O-RING 5mm	1	0.01	FX747-5
7	2083086	SL WIRE ROPE REBAR RING SMOOTH	1	0.34	

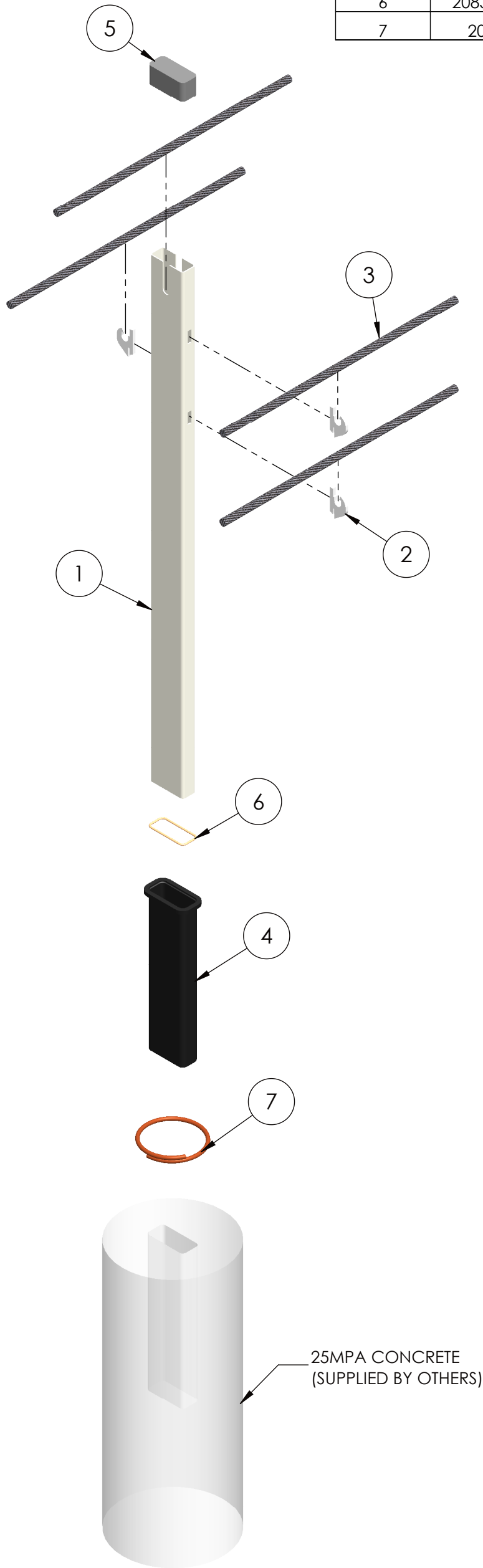

ISO EXPLODED VIEW
SCALE 1:10

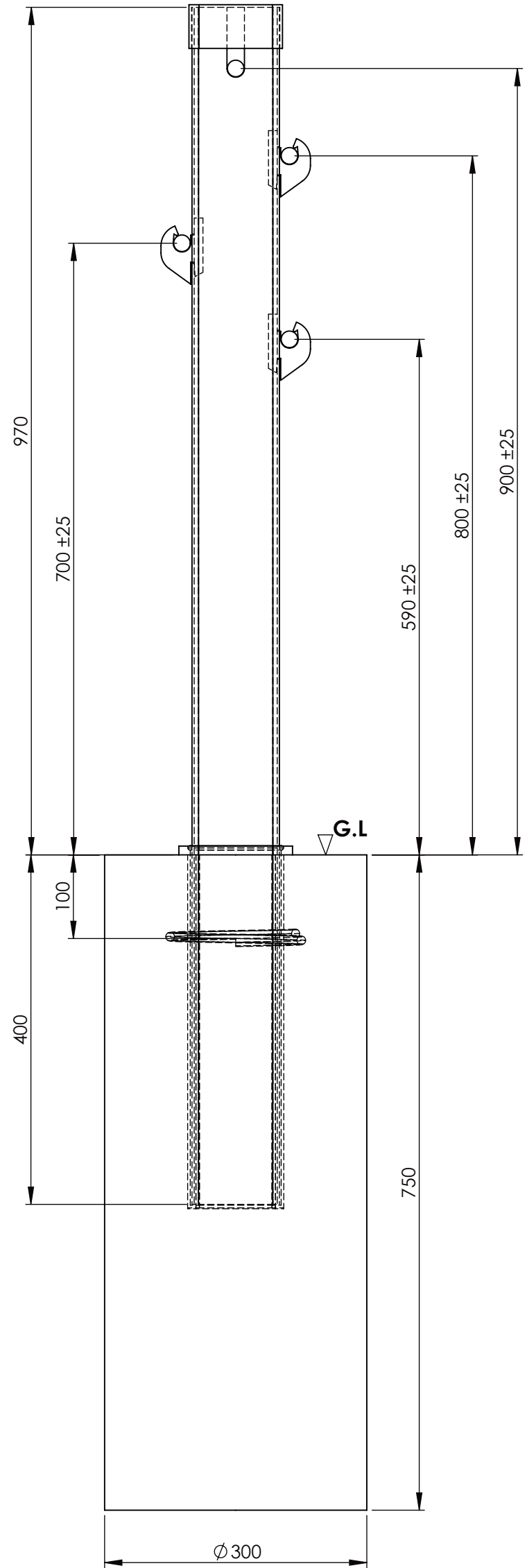

NOTES:



SCALE A3	1:5
ASSEMBLY NO.	2083095SLM
WEIGHT(Kg)	

DESCRIPTION	SF WIRE ROPE POST STD ASSY WHITE - 3 SLOTS
-------------	--

DRAWN	S KERAI
DATE	21/11/2019
DRW NO.	FX747

DESTROY ALL PREVIOUS ISSUES
0
REVISION

ITEM NO.	PART NO.	DESCRIPTION	QTY.	WEIGHT EA.	DWG NO.
1	2083131SLM-A	SL WIRE ROPE LINEPOST 1370mm WHITE - 4 SLOTS	1	7	FX747A-1
2	2110162SLM	SL WIRE ROPE HALF TIE 8mm ALUMINIUM	4	0.04	FX747-2
3	2200036SLM	SL WIRE ROPE 19mm DIA.	AS REQUIRED		
4	2083070SLM	SL WIRE ROPE POST SOCKET	1	0.37	FX747-4
5	2083072SLM	SL WIRE ROPE LINEPOST CAP	1	0.07	FX747-3
6	2083073SLM	SL WIRE ROPE LINEPOST O-RING 5mm	1	0.01	FX747-5
7	2083086	SL WIRE ROPE REBAR RING SMOOTH	1	0.34	

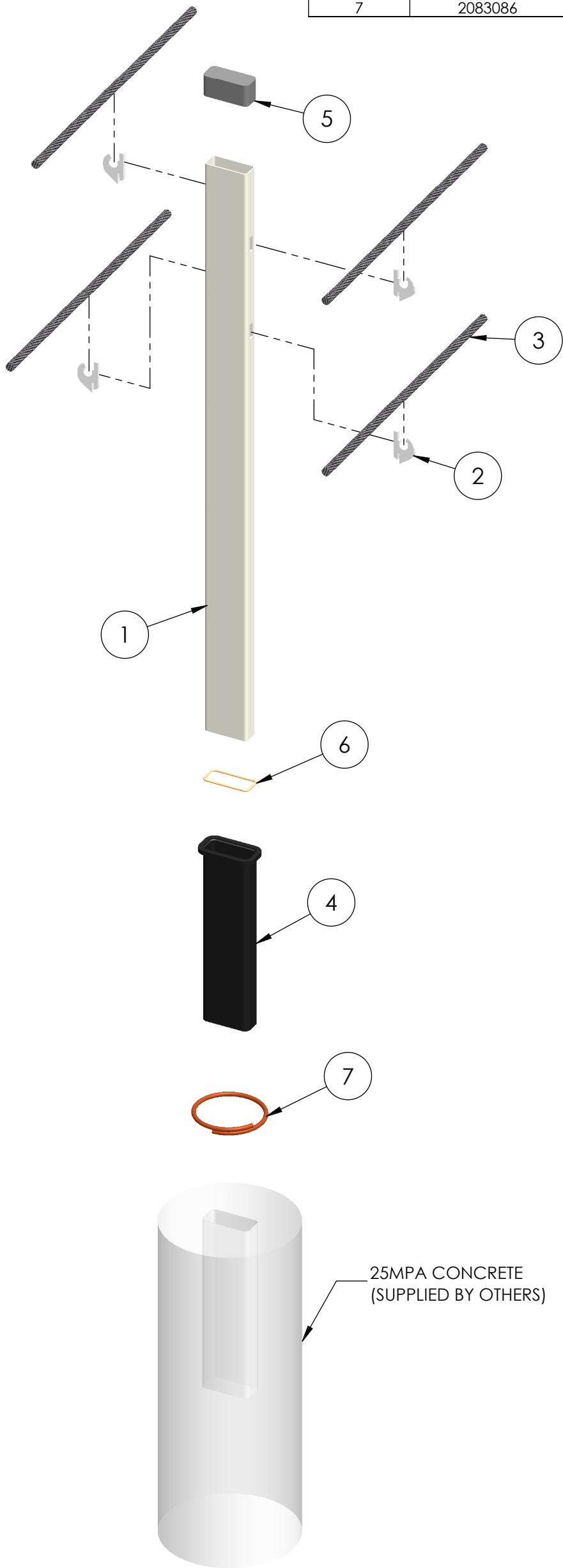

ISO EXPLODED VIEW
SCALE 1:10

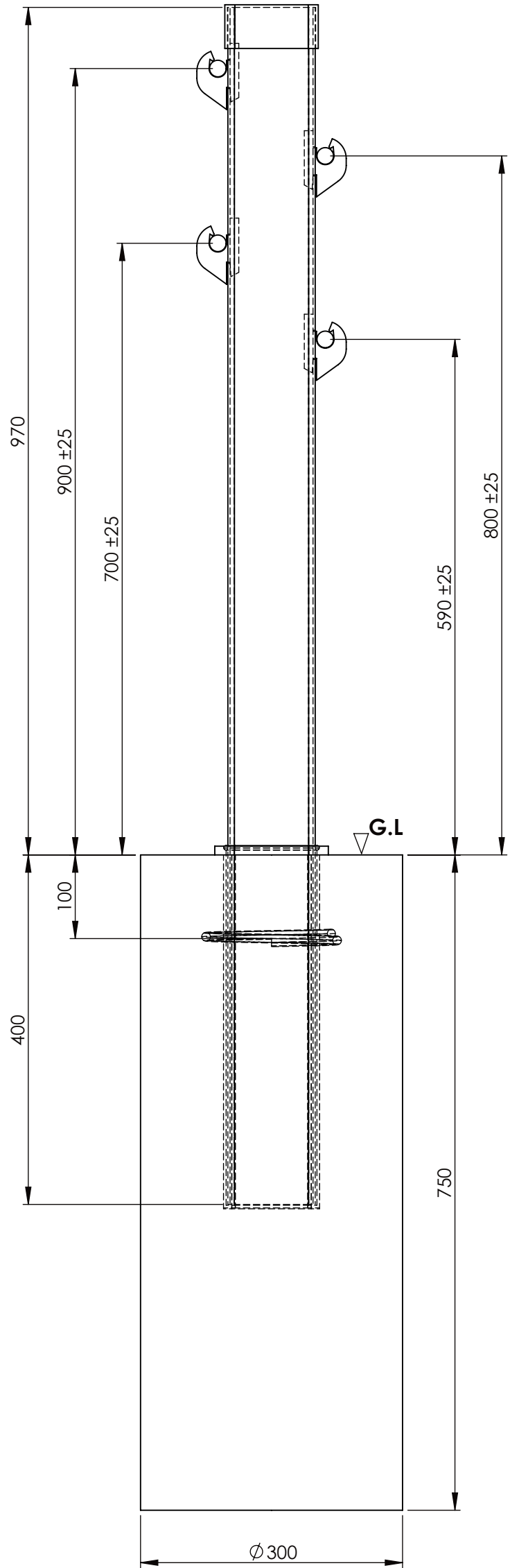

ELEVATION VIEW
SCALE 1:6

NOTES:

306 Neilson Street
Onehunga, Auckland
P O Box 12949, Penrose
Auckland, New Zealand
Telephone: 09 634 1239
Facsimile: 09 634 4525

SCALE A3 1:5
ASSEMBLY NO. 2083095SLM-A
WEIGHT(Kg)

DESCRIPTION
SF WIRE ROPE POST STD ASSY WHITE - 4 SLOTS

DRAWN S KERAI
DATE 21/11/2019
DRW NO. FX747A

DESTROY ALL PREVIOUS ISSUES
0
REVISION