

Safety Base - SB500



SSF50

SHEET NO.	DATE
1 of 3	4/26/2007

INTENDED USE

The Safety Base SB500 post-to-base coupling system utilizes replaceable breakaway couplings for installations on highway signs where proximity requires frangible supports. This system has been developed for use with 6" [150] through 14" [350] wide flange beam supports.

The design of the system is in accordance with the requirements of 2002 AASHTO "Standard Specifications for Structural Supports for Highway Signs, Luminaires, and Traffic Signals".

Installation drawings and specifications, shop drawings and component selection tables are available upon request.

APPROVALS

The SB500 system has been tested in compliance with the guidelines contained in the National Cooperative Highway Research Program (NCHRP) Report 350 "Recommended Procedures for the Safety Performance Evaluation of Highway Features." The Federal Highway Administration (FHWA) granted acceptance in July, 2001.

CONTACT INFORMATION

Safety Base USA Inc.
c/o 1036 Waverly Street
Winnipeg, MB
Canada
R3T0P3

Phone:(204) 896-1333

Fax: :(204) 896-6969

WWW.GROUPWD.COM/SAFETY_BASE

Safety Base - SB500

SSF50

SHEET NO.

DATE

2 of 3

4/26/2007



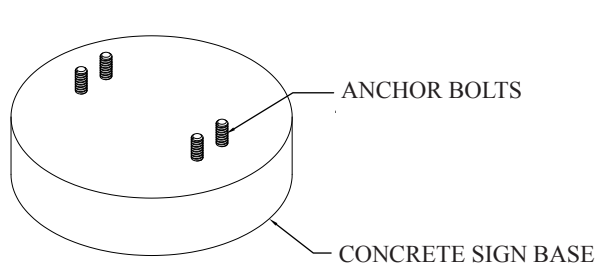

ISOMETRIC VIEW

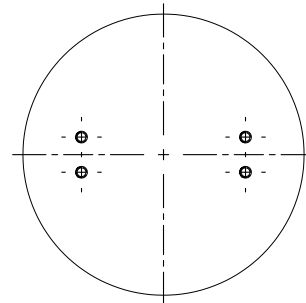

TOP VIEW

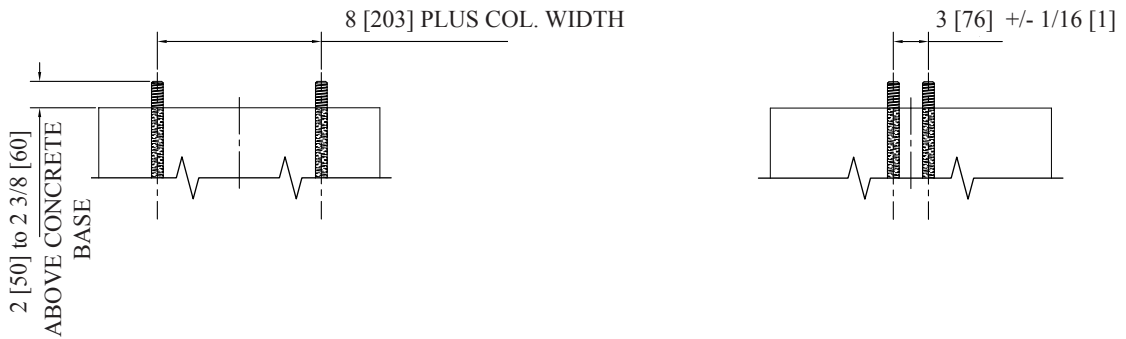

FOUNDATION ANCHOR PLACEMENT

Safety Base - SB500



SSF50

SHEET NO.

DATE

3 of 3

4/26/2007