

Test Installation

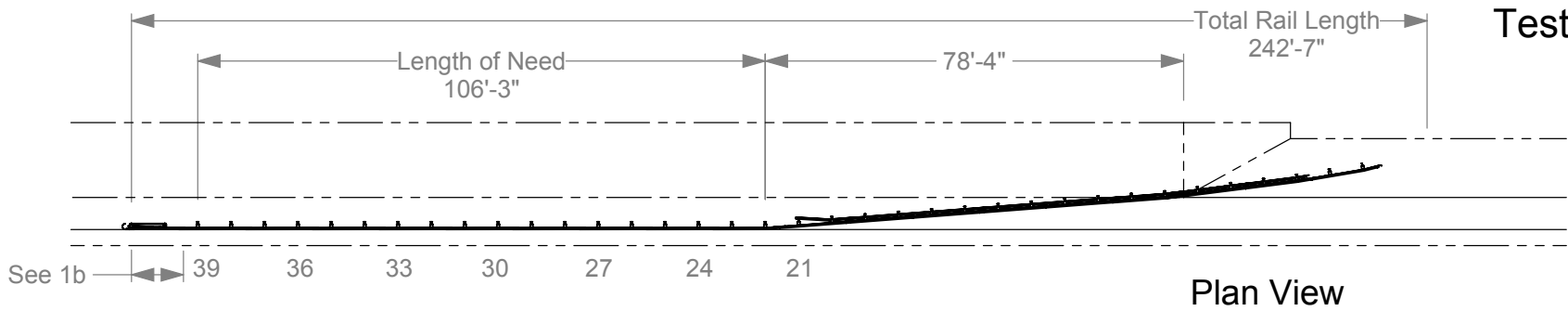

Plan View

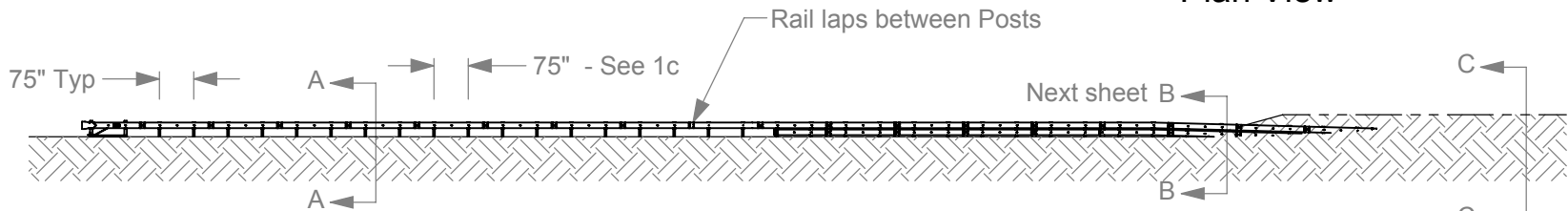

Elevation View

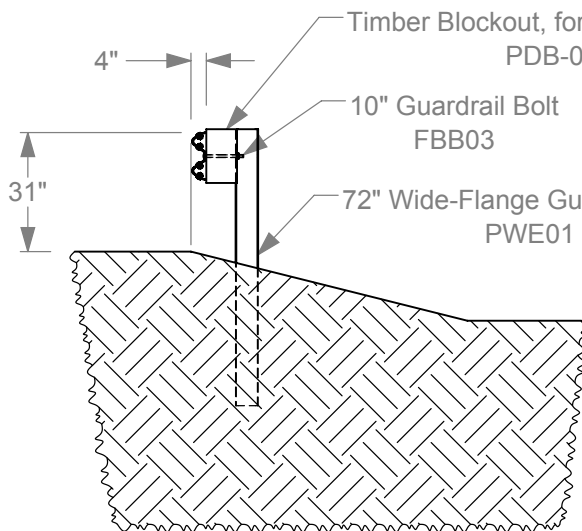

Section A-A

Scale 1 : 50
Post and Rail details typical
in LoN (Posts 22 - 39)

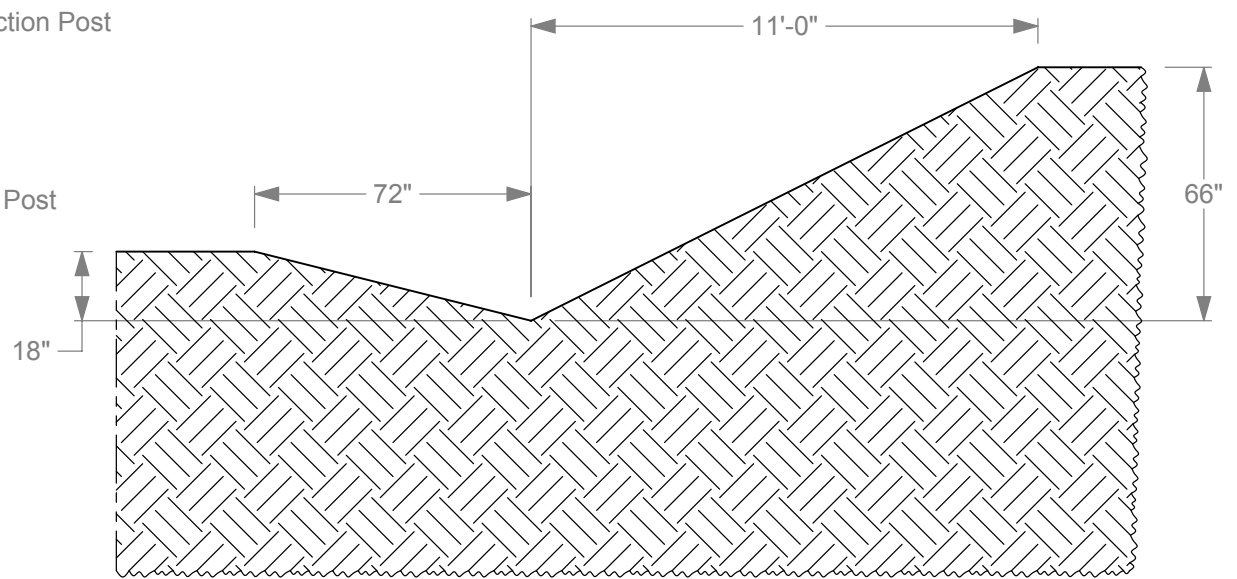

Section C-C

Scale 1 : 50

1a. Backfill Post holes with AASHTO M147-65(2004), grade B crushed limestone road base, compacted to MASH standard.

1b. TxDOT Downstream Anchor Terminal. See attached Drawing #GF 9(31) DAT-14.

1c. 75" Post spacing typical for LoN and Terminal unless otherwise indicated.



Roadside Safety and
Physical Security Division -
Proving Ground

Project #608431 Buried in Backslope

2018-02-02

Drawn by GES

Scale 1:400

Sheet 1 of 6 Test Installation

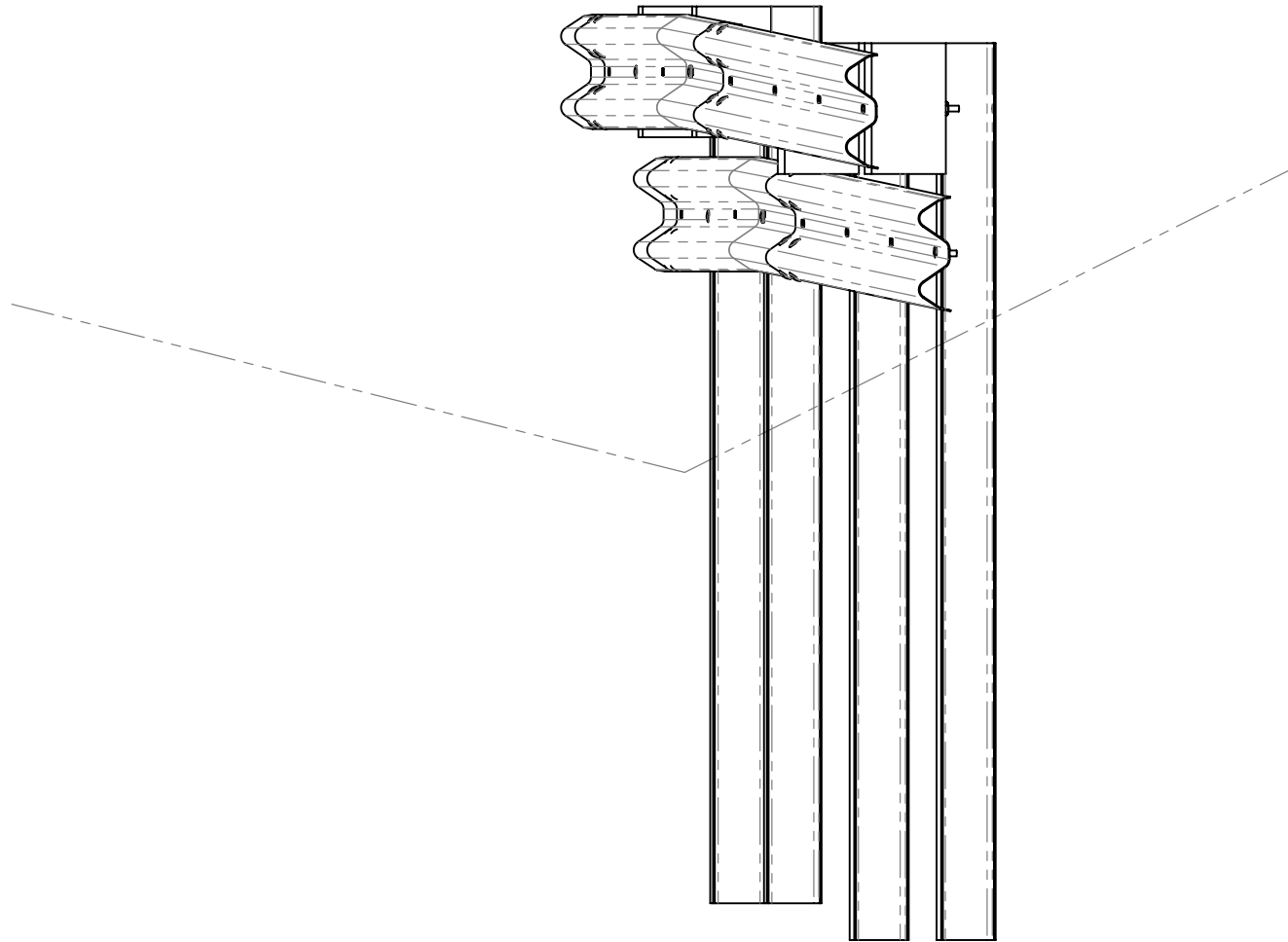

Section B-B

Scale 1 : 20

11 10 9 8

Post Numbers



Roadside Safety and
Physical Security Division -
Proving Ground

Project #608431 Buried in Backslope

2018-02-02

Drawn by GES

Scale 1:400

Sheet 2 of 6 Section B-B

Terminal Details - Elevation

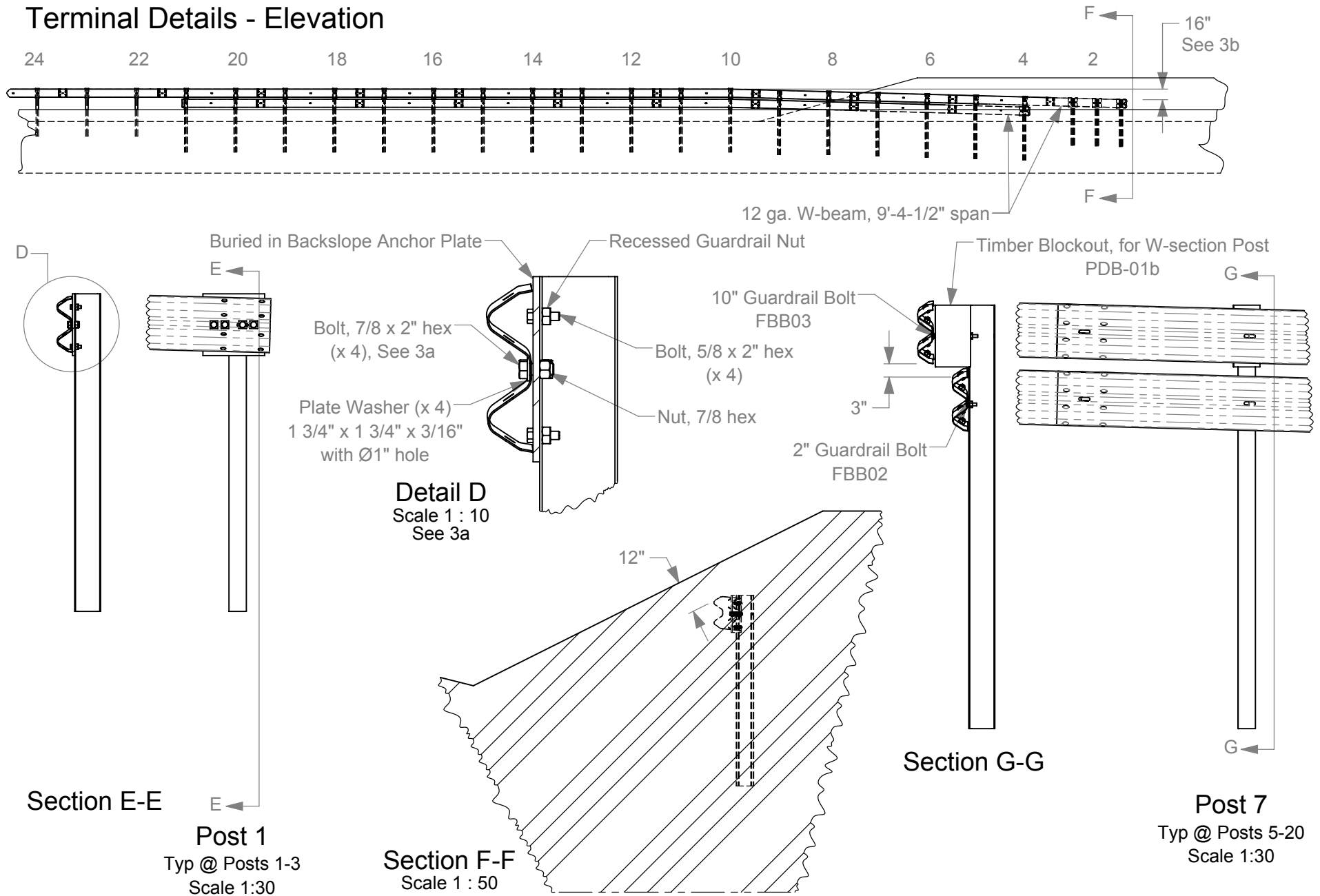

3a. Recessed Guardrail Nuts typical on all 5/8" Bolts. Anchor Plate and hardware are typical on top rail at Posts 1 - 3, and rub rail at Post 4. Field drill Ø1" holes in Guardrail as needed for 7/8 Bolts at Posts 1 - 4. Hex Head bolts are ASTM A307.

3b. Rail height changes 16" from Post 10 to 1 to achieve 12" of soil coverage at Post 1.



Roadside Safety and Physical Security Division - Proving Ground

Project #608431 Buried in Backslope		2018-02-02
Drawn by GES	Scale 1:200	Sheet 3 of 6 Terminal Details - Elevation

Terminal Details - Plan

Ditch and Backslope edges hidden for clarity

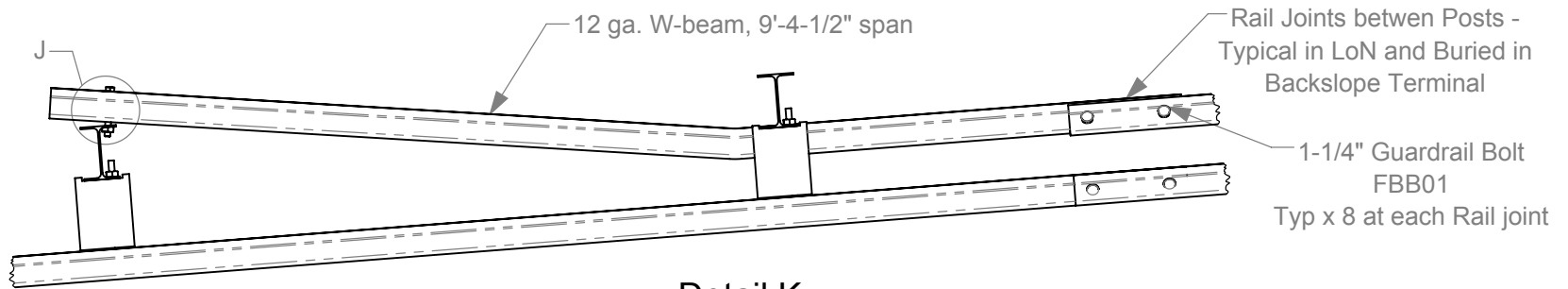
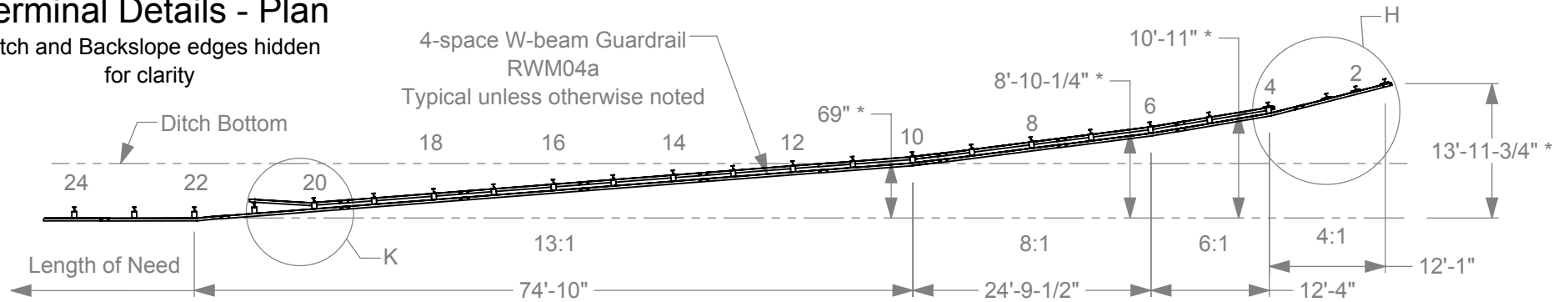

Detail K
Scale 1 : 20

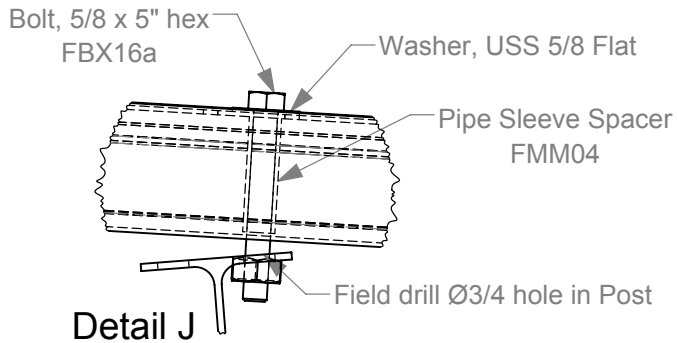

Detail J
Scale 1 : 5

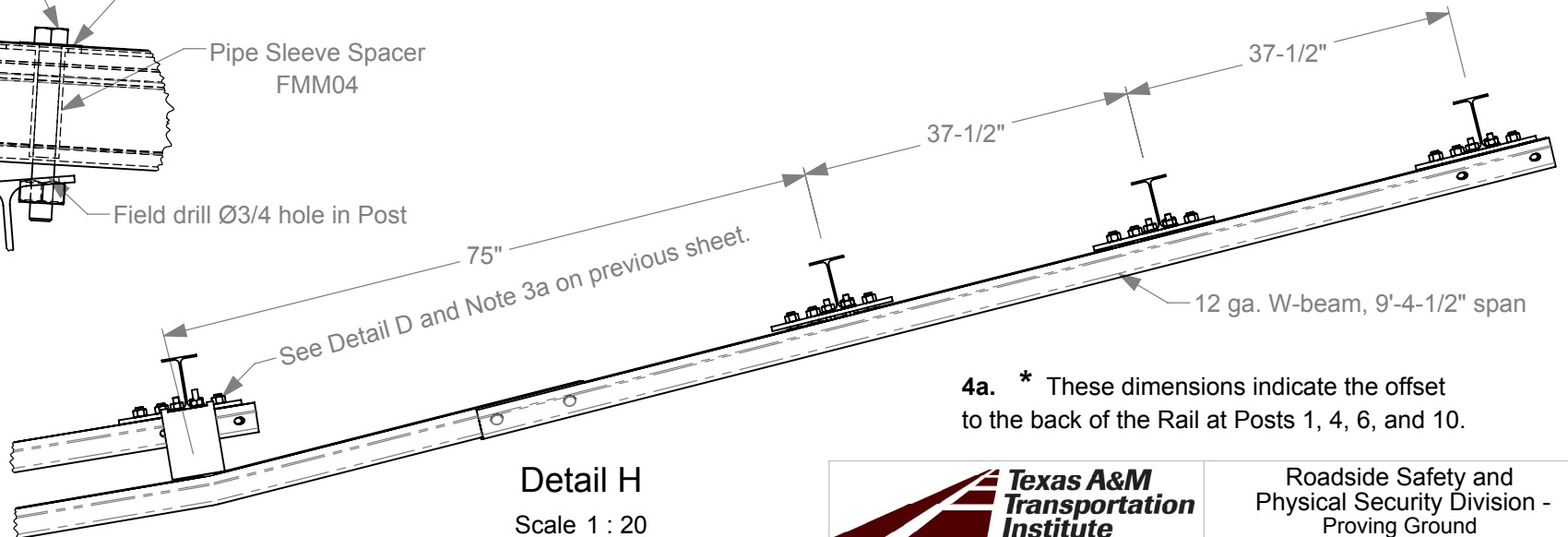

Detail H
Scale 1 : 20

4a. * These dimensions indicate the offset to the back of the Rail at Posts 1, 4, 6, and 10.



Roadside Safety and Physical Security Division - Proving Ground

Project #608431 Buried in Backslope		2018-02-02
Drawn by GES	Scale 1:200	Sheet 4 of 6 Terminal Details - Plan

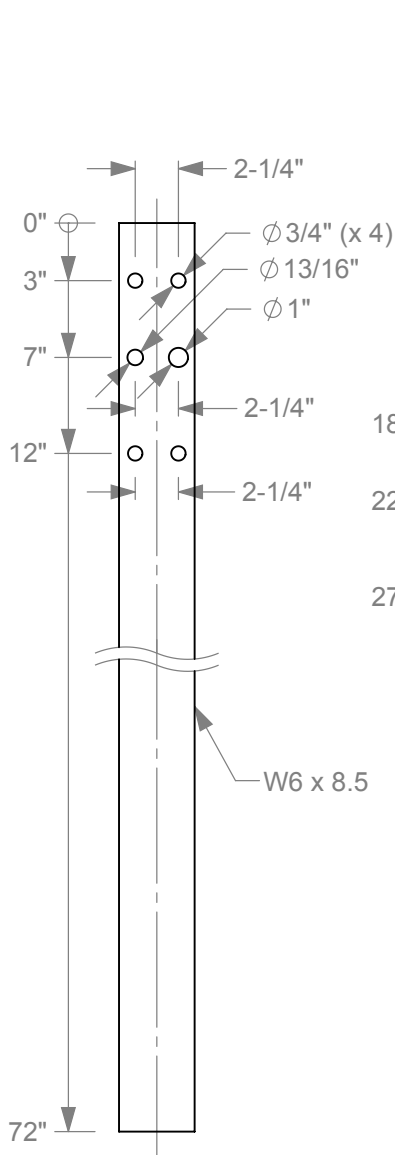

Posts 1 - 3

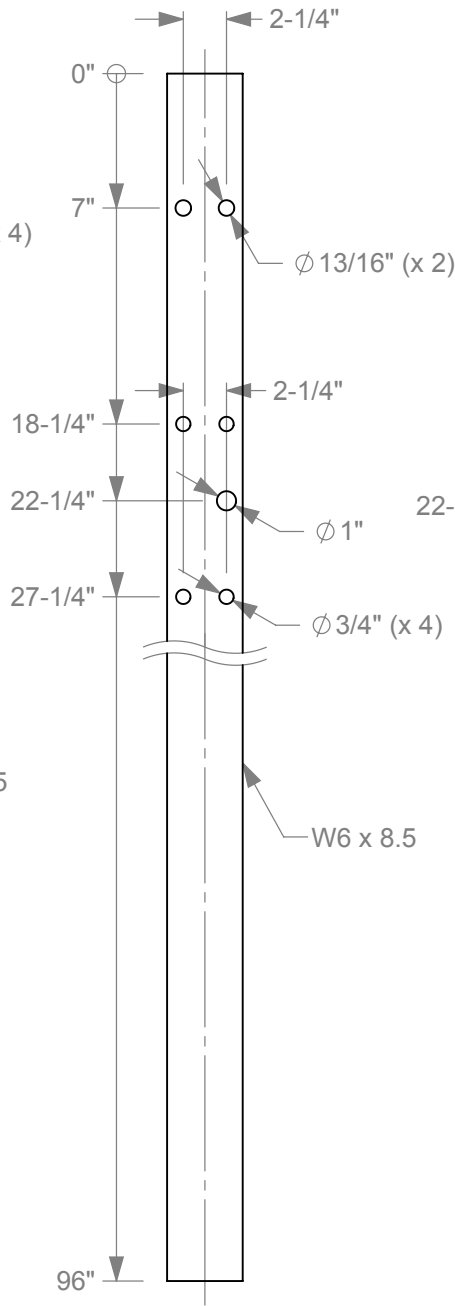

Post 4

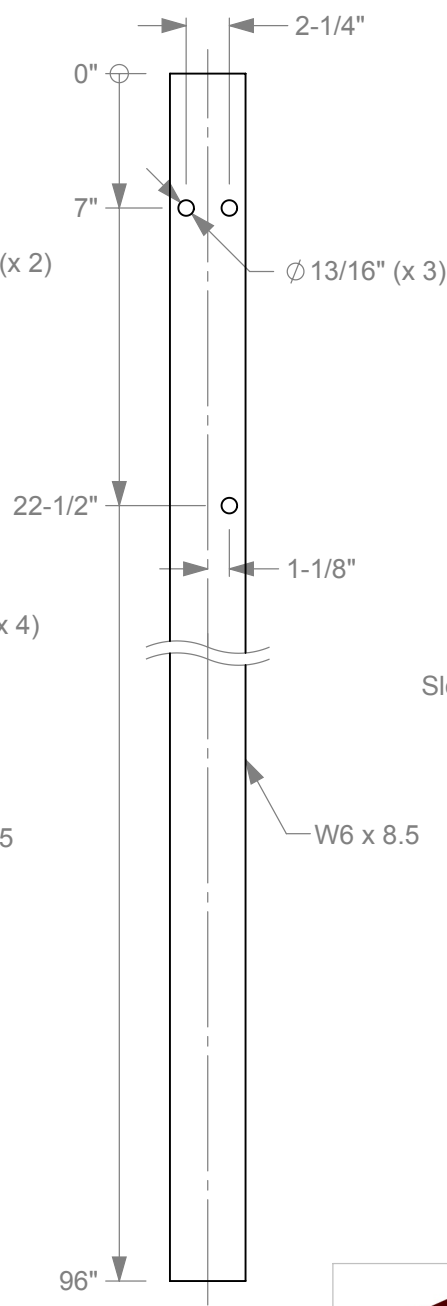

Posts 5 - 21

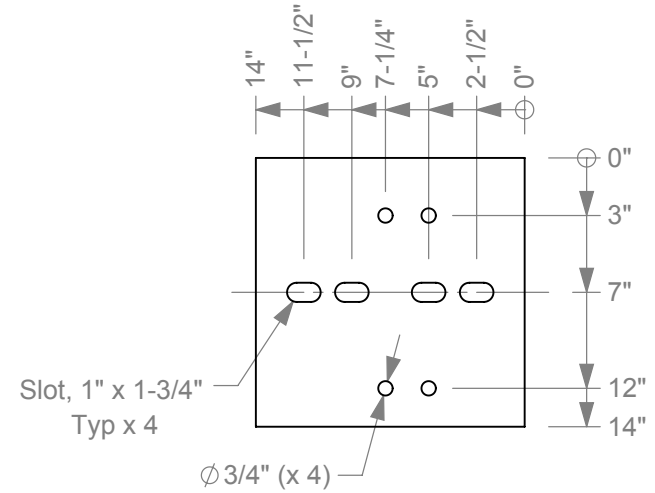

Buried in Backslope Anchor Plate
 Plate, 14" x 1/2" x 14"
 ASTM A36



Roadside Safety and
 Physical Security Division -
 Proving Ground

Project #608431 Buried in Backslope 2018-02-02

Drawn by GES

Scale 1:10

Sheet 5 of 6 Parts

Isometric View

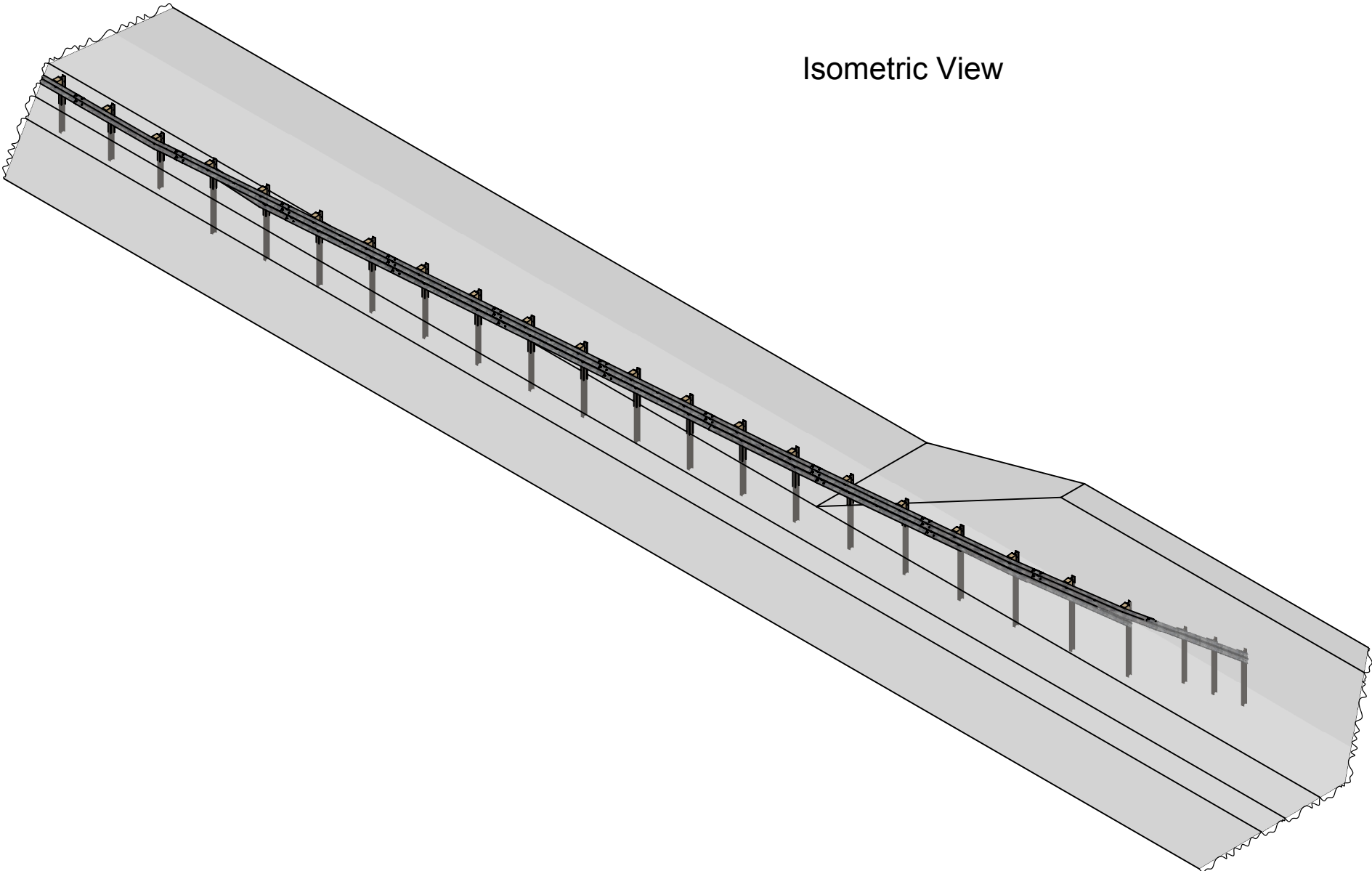

Roadside Safety and
Physical Security Division -
Proving Ground

Project #608431 Buried in Backslope

2018-02-02

Drawn by GES

Scale 1:150

Sheet 6 of 6 Isometric View